

1 2 3 4 5 6 7 8 9

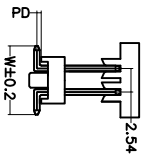

TPYE 1
filler cover

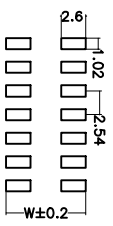
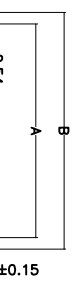
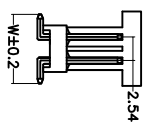
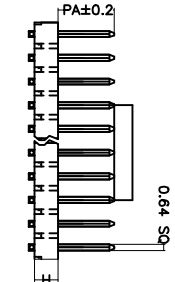
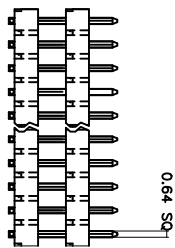

TPYE 2
cover

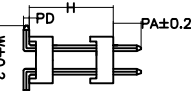

TPYE 3

SPECIFICATIONS
 Current Rating: 3Amps
 Insulation Resistance: 1000MΩ min
 Withstanding Voltage: 1000VAC
 Contact Resistance: 20mΩ max
 Operating Temperature: -40° C to +105° C
 Standard: PBT
 Contact Material: Brass
 Contact Plating: Au or Sn Over Ni
 Max. Processing Temp: 180° C for 30-60second
 (200 C for 10second)

Code Description
CH-254-PH-2-XY-H-W-XY-B

- (0) (3) (4) (5) (6) (7) (8)
 - (1) Pin Spacing: 2.54=2.54mm
 - (2) Product Name: PH=Pin Header
 - (3) No. of Rows: 1=Single 2=Dual Row
 - (4) No. of Pins Per Row: 1-40
 - (5) Insulator Material
 - (6) Contact Type: S=Straight; R=Right/Angle; K=SMT
 - (7) Contact
 - (8) Insulator Material Option:
- Plating: SN=Tin; XTY=12Y, 14Y, 18Y, 20Y, 25Y, 30Y, 35Y; SO=Gold
 Flash/Tin: AU08=Au0.8u''
 A=BK-PBT; B=BK-PA6T; C=BK-PA46; D=BK-1CP; S=Special

慈溪慈惠电子元件厂

Cixi Cihui Electronic Components Factory

UNLESS OTHERWISE SPECIFIED TOLERANCE

X : ±0.3 X* : ±5°
 X.X : ±0.2 X.X* : ±1°
 X.XX : ±0.2 X.XX* : ±0.5°

DRAWN NAME: CH-254-PH-2-XY-H-W-XY-B

SIZE	A4	SCALE	N:1	PRODUCT	
REV	A	UNIT	mm	PROJECT	
				PAGE	1/1

CHECKED	LTD	DATE	CHECKED	DATE
		05/28		/

No. of	DIN. A	DIN. B	No. of	DIN. A	DIN. B	No. of	DIN. A	DIN. B	No. of	DIN. A	DIN. B	No. of	DIN. A	DIN. B
1	0.00	2.54	11	25.40	27.94	21	50.80	53.35	31	76.20	78.74	41	101.60	104.14
2	2.54	5.08	12	27.94	30.48	22	53.35	55.88	32	78.74	81.28	42	104.14	106.68
3	5.08	7.62	13	30.48	33.02	23	55.88	58.42	33	81.28	83.82	43	106.68	109.22
4	7.62	10.16	14	33.02	35.56	24	58.42	60.96	34	83.82	86.36	44	109.22	111.76
5	10.16	12.70	15	35.56	38.10	25	60.96	63.50	35	86.36	88.90	45	111.76	114.30
6	12.70	15.24	16	38.10	40.64	26	63.50	66.04	36	88.90	91.44	46	114.30	116.84
7	15.24	17.78	17	40.64	43.18	27	66.04	68.58	37	91.44	93.98	47	116.84	119.38
8	17.78	20.32	18	43.18	45.72	28	68.58	71.12	38	93.98	96.52	48	119.38	121.92
9	20.32	22.86	19	45.72	48.26	29	71.12	73.66	39	96.52	99.06	49	121.92	124.46
10	22.86	25.40	20	48.26	50.80	30	73.66	76.20	40	99.06	101.60	50	124.46	127.00