

TYPE 1

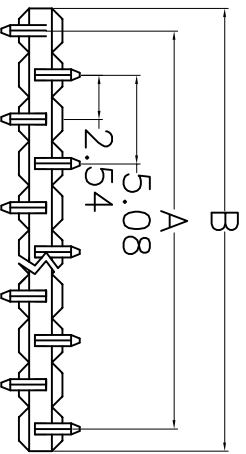

TYPE 2

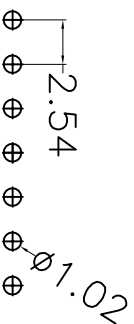
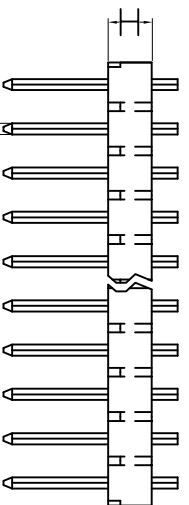

0.64 SQ

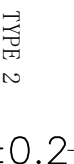
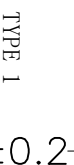

SPECIFICATIONS

Current Rating: 3Amps
 Insulation Resistance: 1000MΩ min
 Withstanding Voltage: 1000VAC
 Contact Resistance: 20mΩ max
 Operating Temperature: -40° C to +105° C
 Standard: PBT
 Contact Material: Brass
 Contact Plating: Au or Sn Over Ni
 Max. Processing Temp: 180°C for 30-60second
 (200°C for 10second)

Code Description

[CH-254-PH-1-XX-H-M-XXX-XXY-B](#)

- (1) Pin Spacing: 254=2.54mm
- (2) Product Name: PH=Pin Header
- (3) No. of Rows: 1=Single 2=Dual Row
- (4) No. of Pins Per Row: 1-40
- (5) Insulator Material
- Height: 150=1.5mm; 200=2.0mm; 254=2.54mm
- (6) Contact Type: S=Straight; R=Right/angle; M=SWT
- (7) Contact Material
- Length: 138=13.8mm; 188=18.8mm; 140=14.0mm
- (8) Contact Plating: SN=Tin; XXY=12Y, 14Y, 18Y, 20Y, 25Y, 30Y, 35Y, 1U, 2U, 3U; SO=Gold Flash/Tin
- (9) Insulator Material Option:
 A=BK-PBT; B=BK-PA6T; C=BK-PA46; D=BK-LCP; S=Special

慈溪慈惠电子元件厂

CiXi CiHui Electronic Components Factory

UNLESS OTHERWISE SPECIFIED TOLERANCE

| | | | |
|------|--------|-------|---------|
| X | : ±0.3 | X° | : ±5° |
| X.X | : ±0.2 | X.X° | : ±1° |
| X.XX | : ±0.2 | X.XX° | : ±0.5° |

DRAWN NAME: CH-254-PH-1-XX-H-M-XXX-XXY-B

| | | | | | |
|------|----|-------|-----|---------|-----|
| SIZE | A4 | SCALE | N:1 | PRODUCT | |
| REV | A | UNIT | mm | PROJECT | ☉ |
| | | | | PAGE | 1/1 |

| | | | | | | | |
|---------|---------------|------|-------|---------|--|------|--|
| CHECKED | LIU SHENG HUI | DATE | 05/28 | CHECKED | | DATE | |
|---------|---------------|------|-------|---------|--|------|--|

| No. of | DIN. A | DIN. B | No. of | DIN. A | DIN. B | No. of | DIN. A | DIN. B | No. of | DIN. A | DIN. B |
|--------|--------|--------|--------|--------|--------|--------|--------|--------|--------|--------|--------|
| 1 | 0.00 | 2.54 | 11 | 25.40 | 27.94 | 21 | 50.80 | 53.35 | 31 | 76.20 | 78.74 |
| 2 | 2.54 | 5.08 | 12 | 27.94 | 30.48 | 22 | 53.35 | 55.88 | 32 | 78.74 | 81.28 |
| 3 | 5.08 | 7.62 | 13 | 30.48 | 33.02 | 23 | 55.88 | 58.42 | 33 | 81.28 | 83.82 |
| 4 | 7.62 | 10.16 | 14 | 33.02 | 35.56 | 24 | 58.42 | 60.96 | 34 | 83.82 | 86.36 |
| 5 | 10.16 | 12.70 | 15 | 35.56 | 38.10 | 25 | 60.96 | 63.50 | 35 | 86.36 | 88.90 |
| 6 | 12.70 | 15.24 | 16 | 38.10 | 40.64 | 26 | 63.50 | 66.04 | 36 | 88.90 | 91.44 |
| 7 | 15.24 | 17.78 | 17 | 40.64 | 43.18 | 27 | 66.04 | 68.58 | 37 | 91.44 | 93.98 |
| 8 | 17.78 | 20.32 | 18 | 43.18 | 45.72 | 28 | 68.58 | 71.12 | 38 | 93.98 | 96.62 |
| 9 | 20.32 | 22.86 | 19 | 45.72 | 48.26 | 29 | 71.12 | 73.66 | 39 | 96.62 | 99.06 |
| 10 | 22.86 | 25.40 | 20 | 48.26 | 50.80 | 30 | 73.66 | 76.20 | 40 | 99.06 | 101.6 |